

# TIP LAMP

## **CLEANING / RENGØRING / SÄUBERN / NETTOYAGE / LIMPIEZA**

**EN** Turn off electricity, clean with dry cloth

**DK** Afbryd elektricitet, rengør med tør klud

**DE** Vom strom trennen, mit einem sauberen, trockenen oder feuchten tuch

**FR** Coupez l'électricité et nettoyez avec un chiffon sec ou humide

**ES** Desconectar la corriente eléctrica y limpiar con el paño seco o húmedo

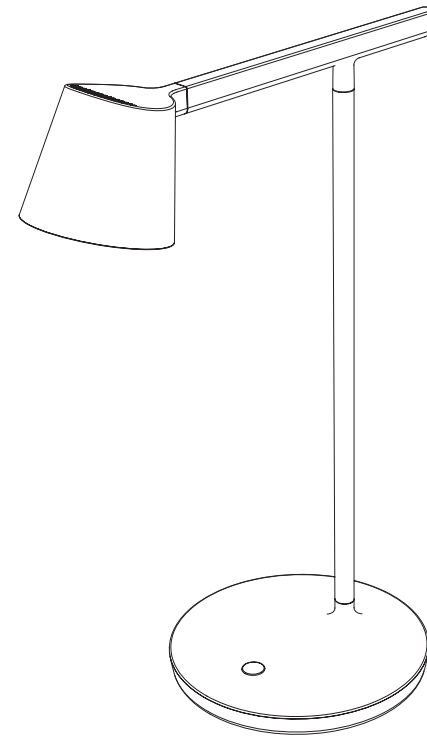

**CONTENT / INDHOLD / INHALT  
/ CONTENU / CONTENIDO**

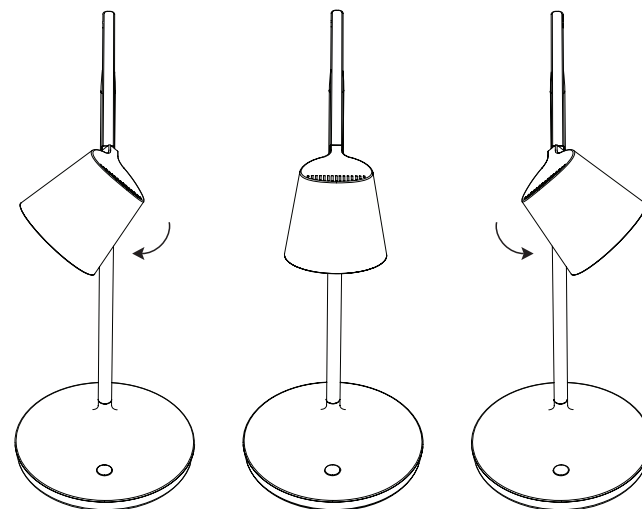
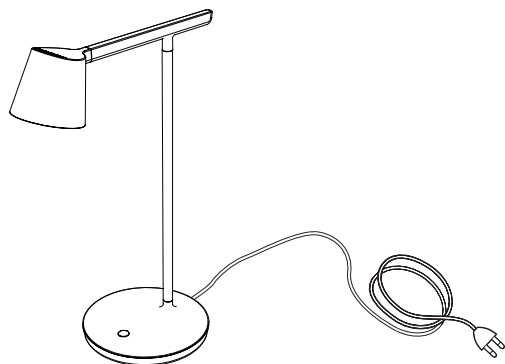

**DIM LIGHT / DÆMP LYSSTYRKEN / LICHT DIMMEN  
/ VARIATEUR / LUZ REGULARODA**

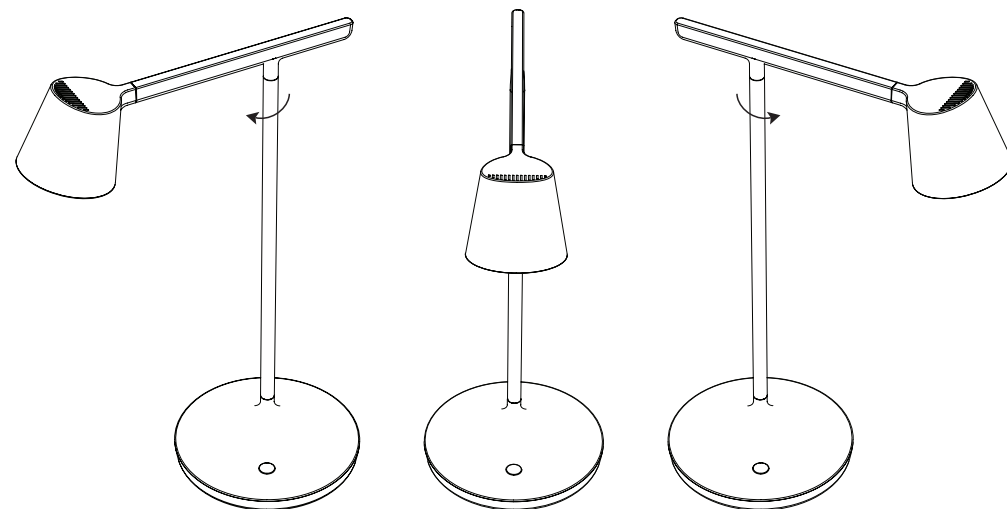
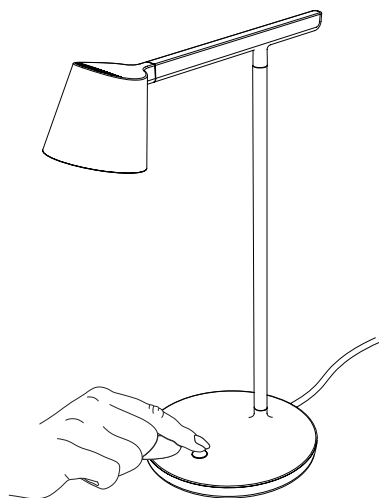

**EN:** Hold in the on/off button to dim light

**DK:** Hold tænd/sluk knappen inde for at lysstyrke

**DE:** An/Aus Knopf drücken um zu dimmen

**FR:** Maintenez une pression prolongée sur le bouton afin de régler l'intensité désirée

**ES:** Mantenga el botón de encendido/apagado para atenuar la luz

Item: Tip Table Lamp  
Input: 220-240V ~ 50/60Hz  
Output: 20V DC  
LED Max. 7 W

